

# Basic Series • Square Panel Meters

For Voltage ( Double Pointer-Type Voltage Meter )



## Description

Analog Panel Meter with moving-coil movement and Spring-Load Pivot Bearings

## Displays

Scale Division Coarse-fine  
Pointer Knife Edge Beam Pointer per-DIN

## Mechanical Design

Housing Material Polycarbonate, self-extinguish and drip-proof per UL94V-0  
Mounting Fastener Screw Clamps  
Scale Interchangeable scales Scales can only be replaced under voltage-free conditions!  
Replaceable Front frames . glass windows and scale plate Scales may only be replaced under voltage-free conditions  
Terminals Self-lifting terminal. Screws can be turned with a cross-head or standard screw driver  
Contact Protection Finger-safe terminal

**Moving-Iron Movement, 90° scale white, imprint black**  
**Narrow front frame matt black per DIN 43718, anti-glare glass**

Technical Specification	Model	
	DVP96	DVP144
Scale Length, mm	97	145
Accuracy Class	1.5%	1.5%
Approx. Weight	0.35k g	0.5k g
Max. Operating Voltage	600V	600V
Test Voltage	5.8k V	5.8k V
Front Housing -Panel Protection	IP52	IP52

## Reference Conditions

Reference Quantities	Reference Conditions
Ambient Temperature	23°C ± 2°C
Position of Use	Ctrl Panel Vertical ± 1°
Frequency	45 ... 65Hz
Other	DIN EN 60051

## Power Consumption

Connection	Measuring Input		Power Consumption
Direct Connected	Voltage	10V ... 600V	approx. 2.5VA
Transformer Connected	Voltage	sec.: 110V or 230V	per input

## Nominal Range of Use Limits

Frequency	for alternating Current 45 ... 65Hz for alternating Voltage 45 ... 65Hz
-----------	----------------------------------------------------------------------------

Basic Dimensions

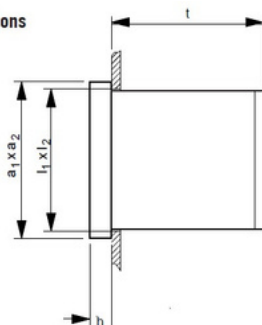

Connection Diagram

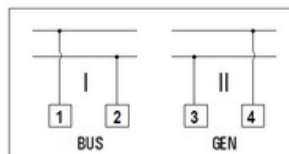

DVP 96

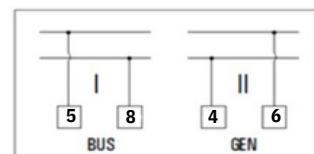

DVP 144

Model	Front in mm a1 x a2	Cutout Dimensions, mm l1 x l2	Installation Depth (t), mm
DVP 96	96 x 96	93 x 93	65
DVP 144	144 x 144	138 x 138	60